

# Photovoltaic Fuses

## gPV Fuses

# PV1500E Series

The PV1500E Series solar fuse is designed to integrate into an in-line assembly within a wire harness. The PV1500E Capable of withstanding high cycling and low level fault current conditions.



### Features

- Compliance with US Requirements
- Ceramic Body construction
- RoHS compliant
- Designed to UL 248-19 Recognized
- Low watts loss



### Part Numbering System

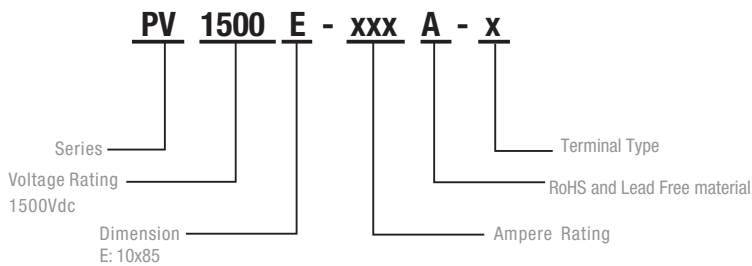

### Specification

Part Number	Current Rating (A)	Voltage Rating	Interrupting Rating	Energy Integrals I2t (A2S)		Power loss @1.0 In (W)
				Pre-Arcing	Total at 1500V	
PV1500E-2A	2	<b>1500VDC@30kA</b>		3.5	10	2.6
PV1500E-4A	4			15	50	2.8
PV1500E-5A	5			22	75	3.2
PV1500E-10A	10			300	1100	4.2
PV1500E-12A	12			20	60	4.2
PV1500E-15A	15			35	95	5.0
PV1500E-20A	20			115	820	6.2
PV1500E-25A	25			175	1300	5.7
PV1500E-30A	30			241	1950	7.5

- DC Interrupting Rating - Measured at designated voltage, time constant < 50 microseconds.
- Typical Melting I t measured at 10In Current.
- Typical Voltage Drop measured at rated current after temperature has stabilized.

# gPV Fuses

## Photovoltaic Fuses

## PV1500E Series

### Dimension (Unit: mm)

### Package/MOQ

Standard cylindrical, ordering code - PV1500E-xxA ( 2A~15A)

PV1500E-xxA: 28pcs fuses in one carton;  
PV1500E-xxA-I : 40pcs fuses in one carton.

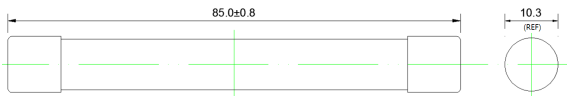

In-line crimp terminal type, ordering code - PV1500E-xxA-I( 2A~15A)

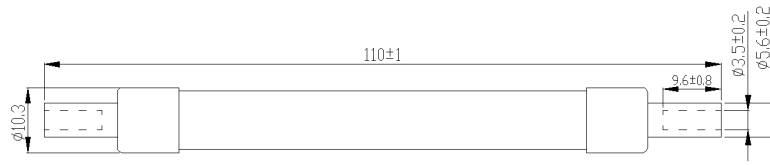

Note: for 10-12AWG (6-4mm<sup>2</sup>); Recommended Crimping Tool: T&B Sta-Kon ERG4002 or equivalent .

Standard cylindrical, ordering code - PV1500E-xxA ( 20A~30A)

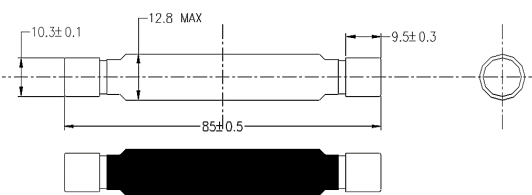

In-line crimp terminal type, ordering code - PV1500E-xxA-I( 20A~30A)

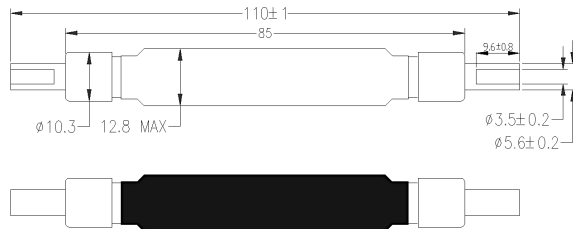

Note: for 10-12AWG (6-4mm<sup>2</sup>); Recommended Crimping Tool: T&B Sta-Kon ERG4002 or equivalent .

### Temperature Re-Rating Curve

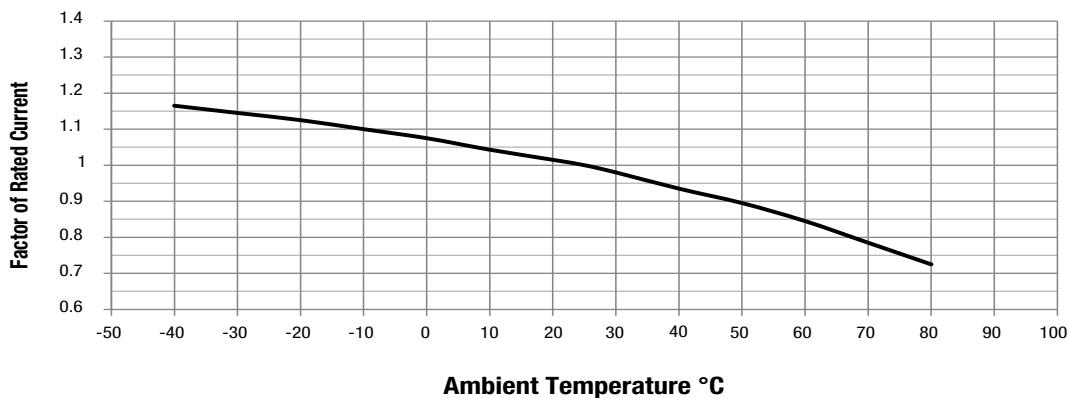

# gPV Fuses

## Photovoltaic Fuses

## PV1500E Series

### Time Current Curve

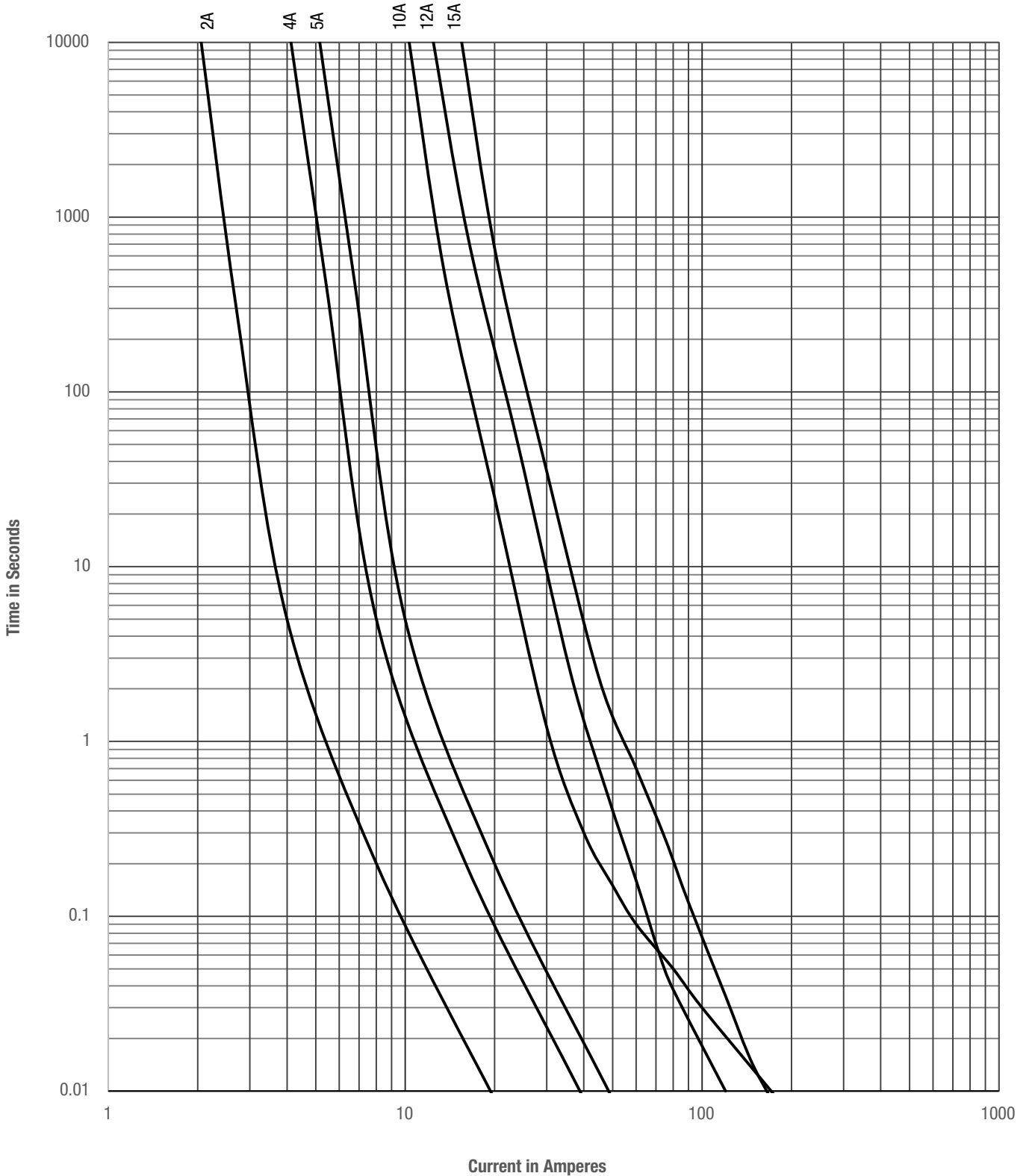

**gPV Fuses**

**Photovoltaic Fuses**

**PV1500E Series**

**Time Current Curve**

